

Camera Setup Instruction

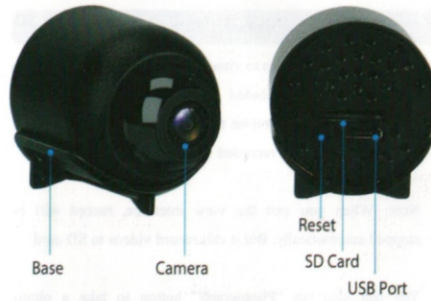

App: HomeEye

Product Structure:



Set up your camera

1. Step One – Phone application download and installation

- Download and install the application called "HomeEye" on Google Play Store for Android or App Store for IOS.
- You may scan the QR code on first page on manual as well.

NOTE:

- Enable "Run in background" and "Trust this app" for the Android Phone.
- Please allow all tips when you open the app firstly. Otherwise the app will fail to run.

2. Step Two – Camera setup

- Insert a Micro SD card into device. Recommend using SanDisk brand. If you use 64GB or 128GB Micro SD card, you need to enter app settings and format it.
- Connect the device with USB Charger or Power Bank
- Wait for the red indicator light to blink.

3. Step Three – Add device

- Open the WLAN settings (Wi-Fi settings) from your phone.
- Connect to your Wi-Fi network.
- Launch app and click "+" button, next click "Device scan code distribution network" button.
- Select connected Wi-Fi network and enter the password.
- Please place the QR code on your phone towards the camera lens at a distance of about 15~20cm (6~7.8inch) to let the camera scan the QR code.
- When connected successfully, the device will be automatically added and keep online. If connected fail, please reset the device and re-connect device.

Note: upper and lower letter case for Wi-Fi password.

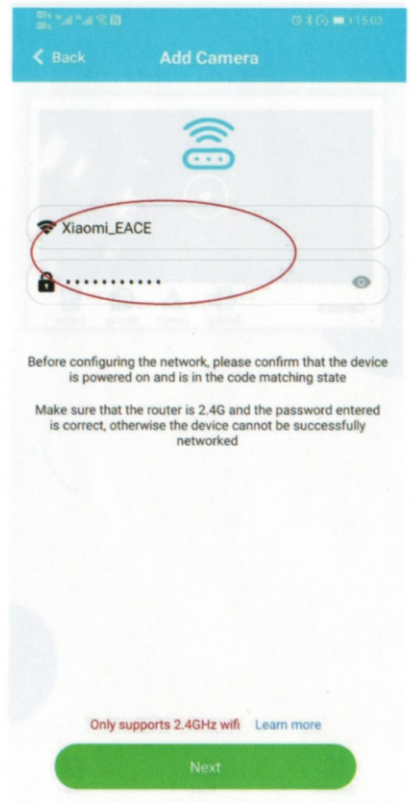
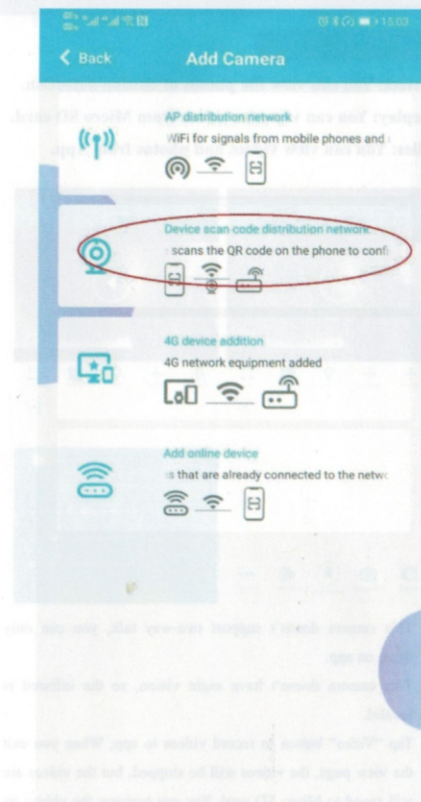



Camera Interface and Setting

1. Camera Interface

Detect: You can view the photos of motion detection.

Replay: You can view the videos from Micro SD card.

Files: You can view videos and photos from App.

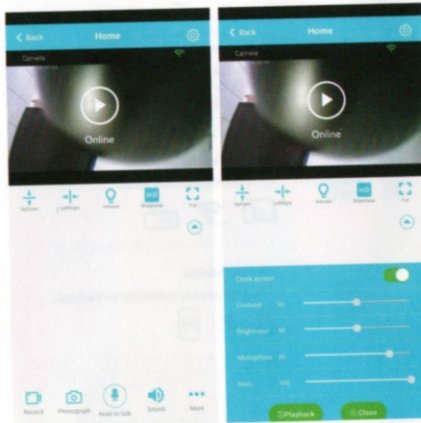

- This camera doesn't support two-way talk, you can only listen on app.
- This camera doesn't have night vision, so the infrared is invalid.
- Tap "Video" button to record videos to app; When you exit the view page, the videos will be stopped, but the videos are still saved to Micro SD card. You can preview the videos on **Files** of main page.

- Tap "Photograph" button to take a photo to app.
- Please tap "More" button, next tap "Playback" button to view, download and delete video files from Micro SD card.
- Tap "Indicator light" button to turn on/off the device indicator light.

Setting

- User Settings:** You can set a new password. After that, the device will be automatically restarted. Please wait for a while, next the device will be online again.
- Time Settings:** When the time is not correct, please click "Sync Phone Time" button to correct the time.
- Alarm Settings**
 - Motion detection:** You need enable the function if you want to set alarm push or recording.
 - Motion detection sensitivity:** High/Middle/Low
 - Alarm push:** The device will send a push notification to your phone when a motion is detected.
 - Alarm video duration(s):** The device will record a 10-60 seconds short videos to Micro SD card when a motion is activated.
 - Alarm time delay(s):** For example, you set 30s, it will record video after 30s when a motion is detected.
- SD Card Settings**
 - SD Total(M) an SD Remainder(M):** You will know if the device detects the SD card via the

value. If not, please click "Format SD card" button. Next wait for a while, the device will restart and you can check that again on this page.

Note: Please turn off the device to insert or unplug SD card.

b. Record time: 5-30 minutes/file in Micro SD card
If you select 30 minutes, the device has to work at least 30 minutes, otherwise there are not files in SD card.

c. Video stream: 720P/1080P

d. Video mode:

Privacy mode: Don't record video to SD card

Throughout the video: Record videos to SD card all the time

Alarm video: Only record video to SD card when a motion is activated.

Timing video: Only record video to SD card at a preset time.

e. Record audio: Record video with audio to SD card when you enable the function.

f. Video coverage: The newest files will overwrite the oldest files when the capacity of SD card is full.

Note: If you enable alarm video, you need to turn on the motion detection on under Alarm settings firstly.

Note: Make sure to "Save" whenever you change any settings.

FAQs

1. How to record video and snapshot to app without SD card?

Tap your camera button to view interface. Tap "Video" button to record videos. Recorded video files are saved to App. Please tap "Files" button on the main page, next tap "video" button to preview the recorded video.

Note: When you exit the view interface, record will be stopped automatically. But it still record videos to SD card.

You can also tap "Photograph" button to take a photo. Snapshots are also saved to App. Please tap "Files" button on the main page, next tap "Photo" button to preview the snapshot.

2. How to record videos to Micro SD card and playback videos from Micro SD card?

Please turn off device first. Insert a Micro SD card into device. Turn on device again. You should be able to see it if the device detects Micro SD card under "SDCard Settings". If not, you may unplug SD card from device and plug SD card into device again or change new SD card into device.

Please tap camera to view interface, next tap "More" button and "SD Playback" to preview the recorded videos from Micro SD card.

3. How to set motion detection record?

Go to Alarm Settings and enable "Motion detection switch" button, select motion detection sensitivity.(high/normal/low), select "Alarm video duration" and "Alarm time delay", Tap "Save" button; Then go to "SDCard Settings", Select "Record time", "Video mode" or other settings, next tap "Save" button.

If you enable motion detection, but you select "Throughout video" or "Timing video" on video mode, the device only sends a push notification to your phone and take a photo to app.

4. How do other users add to the device?

- Make sure another user download app.
- Enter settings, next you will see the QR Code.
- Open app on another user's phone >> Tap "+" button on the top-right corner >> Tap "Add online device" button >> Tap "Scan QR code" button to add the device.

5. How to reset the device?

Please press and hold the "reset" button for 10s. When the device is reset successfully, the red indicator light will flash slowly.

6. I can't view the live video when away from home.

- Please connect the device to your home Wi-Fi. (Set up the device with 4 steps on manual)
- Please make sure that your phone network allows the app to use.